

DIRECT



MOVES



Bumpers Lane

, Portland DT5 1FZ

- Well presented two bedroom home built in 2020
- Own parking with access into the well proportioned rear garden
 - Family bathroom and a downstairs W/C
- A wide range of amenities in the nearby Easton
- Spacious accommodation throughout with two double bedrooms
- Modern fitted, fully integrated kitchen with outlook and door onto garden
- Highly popular residential area with nearby coastal walks
- Truly 'turn key' with attractive presentation and quality finish.

£275,000 Freehold



Entrance Hall

Nice open entrance with access into living room space, downstairs W/C, kitchen, and staircase to upstairs, a radiator and a thermostat.

Lounge/Diner

17'4" x 10'9"

Front aspect room with a large double glazed window with double panel central heating radiator underneath.

WC

5'11" x 3'10"

Front aspect W/C with a double glazed window, low level W/C, a hand wash basin with storage and a radiator.

Kitchen

10'9" x 8'2"

A fully integrated kitchen featuring a range of eye and base level units with a Gas hob, Electric oven and grill with extractor fan above, a dishwasher a window looking onto the rear garden, a door onto the rear garden and under-stair storage.



Landing

Rear aspect double glazed window with double panel radiator underneath, a door opening into a storage cupboard and doors opening into all upstairs rooms.

Bedroom One

14'2" x 8'5"

A well proportioned double bedroom with plenty of space for storage, a front aspect double glazed window with a double panel radiator beneath.

Bedroom Two

10'11" x 10'11"

Another spacious double bedroom with a large front aspect double glazed window, plenty of space for storage, a thermostat, built in wardrobes and storage shelves.

Bathroom

7'0" x 3'10"

Family bathroom with two rear aspect double glazed frosted windows, a built in W/C and hand wash basin, a heated towel rail, a modern bath with glass screen and shower attachment and an extractor fan.

Garden & Parking

A well proportioned, mainly laid to lawn garden with a pleasant patio with a walkway leading to rear access. The space is fully fence enclosed and features doors into the kitchen and the living room.

Disclaimer

Direct Moves Estate Agents make no

representations or warranties regarding the accuracy, completeness, or reliability of the property details provided. These details are for informational purposes only and should not be relied upon in any way. The information is not intended to form part of any contract and does not constitute an offer or guarantee by Direct Moves.

Should you wish to proceed with an offer on this property, we are obligated by HMRC to conduct mandatory Anti-Money Laundering Checks. We outsource these checks to our compliance partners at Coadjute and they charge a fee for this service.



Local Authority
Council Tax Band **B**
EPC Rating **B**

GROUND FLOOR



1ST FLOOR

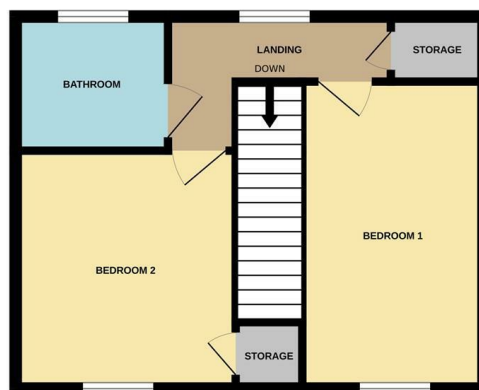

Whilst every attempt has been made to ensure the accuracy of the floorplan contained here, measurements of doors, windows, rooms and any other items are approximate and no responsibility is taken for any error, omission or mis-statement. This plan is for illustrative purposes only and should be used as such by any prospective purchaser. The services, systems and appliances shown have not been tested and no guarantee as to their operability or efficiency can be given.
Made with Metropix ©2026

Direct Moves Estate Agents Office

9 Westham Road
Dorset
Weymouth
DT4 8NP

Contact

01305 778500
sales@directmoves.com
<https://directmoves.com/>

Agents Note: Whilst every care has been taken to prepare these particulars, they are for guidance purposes only. All measurements are approximate and for general guidance purposes only and whilst every care has been taken to ensure accuracy, they should not be relied upon and potential buyers/tenants are advised to recheck the measurements.